



## Kenburn Select KH50 Semi-Automatic Horizontal Baler



The KH50 produces high density bales of a wide range of materials including cardboard, paper / board trim, expanded foam, plastic bottles, aluminium / steel UBC's / cans.

Incorporating full safety features, the KH50 Model is designed for semi-automatic feeding into a top mounted hopper by means of a feed conveyor or from a mezzanine platform/MRF system.

### KEY FEATURES

- 50 Tons main pressure on the pressing ram
- Fed through a top feed hopper by means of a second floor or a conveyor. The machine can also be fed 'by hand' through the access door in the feed hopper.
- 5 Slots for placing strap / wire
- Produces high density mill sized bales
- Wire, steel/plastic strapping can be used to tie bale
- Automatic baling sequence with manual tie-off

Issue 2

November 2017



Kenburn Waste Management Limited Kenburn House Porters Wood  
St Albans Herts AL3 6HX Telephone 01727 844988  
Email [sales@kenburn.co.uk](mailto:sales@kenburn.co.uk) [www.kenburn.co.uk](http://www.kenburn.co.uk)

Registered Office Church View Chambers 38 Market Square Toddington Dunstable Beds LU15 6BS  
Registered in England No: 2132685





- Large feed opening
- Access door in hopper (interlocked for safety)
- Incorporates bale retaining clappers
- Hydraulic drive system
- Hydraulic end door lock/release with safety catch
- Bale size: 1150 x 1000 x up to 1500 mm long.
- Hydraulic Motor power 18.5kw main drive / 0.55kw door locking
- Door locking is hydraulically operated with a two push button control for safety
- Electrical panel to be manufactured from stainless steel and the electrical system to be IP65 protection
- Hopper feed opening: 1350 long x 950 deep x 1000mm wide
- Unit is fitted with a shear blade
- Production of up to 80 tonnes per week depending upon material
- Machine weight approx. 5.5 tonnes

## SPECIFICATION

**Main Frame:** Fabricated mild steel and standard rolled steel sections to form a rigid frame. Bale chamber manufactured to accept strapping machine

**Ram Unit:** Fabricated mild steel sheet and channel to form a robust frame. Base and top guides fitted with steel wear plates. Top cover provided to prevent material entering machine when ram is moving. Limit switches incorporated to control forward and reverse of the ram travel. Safety switches fitted to feed door(s) to prevent ram moving forward with door(s) open. Rear guard removable to provide ready access for maintenance and cleaning.

**Electrical:** Programmable logic controller for main system with contactor for main motor drive (15kW). Integral control panel with push buttons for forward, stop and reverse. Ram stops automatically when bale is at the required density – amber flashing light illuminates on semi-automatic models. Photocell sensing commences operating cycle on semi-automatic models. Conveyor contactor and top level photocell can be fitted as an extra in existing control panel. If machines is left idle for three minutes, stand-by mode is automatically initiated.

Issue 2

November 2017



Kenburn Waste Management Limited Kenburn House Porters Wood  
St Albans Herts AL3 6HX Telephone 01727 844988  
Email [sales@kenburn.co.uk](mailto:sales@kenburn.co.uk) [www.kenburn.co.uk](http://www.kenburn.co.uk)

Registered Office Church View Chambers 38 Market Square Toddington Dunstable Beds LU15 6BS  
Registered in England No: 2132685





**Feed:** Semi-automatic feed hoppers fitted with side access door and photo cell to operate ram cycle. If feed conveyor fitted, the press is equipped with photo sensor to control conveyor feed.

**Hydraulic System:** System incorporates easily replaceable cartridge air and oil filters. System fully tested prior to delivery. Capacity of oil reservoir: 300 litres.

**Strapping:** Strapping manually through five slots in the bale chamber while bale is under ram pressure. Bale ties can be steel baling wire, steel strapping or plastic strapping.

**Bin feeding:** Optional bin feeding system available for applications where material comes from various sources.

**Bale size:** 1070 x 1000 x 1250mm

**Bale weight: approx.** 150 – 600 kg depending on material

**Ram cycle time:** 45 seconds

**Throughput:** 3 to 4 bales per hour, depending upon material

Note: Floor on which baler is installed must be sound and capable of taking the machine weight (4000kg)

## BALE WEIGHTS

Polythene: up to approx. 600kg

Cardboard: up to approx. 500kg

Plastic bottles: up to approx. 300kg

*Bale weights may vary depending on the condition of the material*

Issue 2

November 2017



Kenburn Waste Management Limited Kenburn House Porters Wood  
St Albans Herts AL3 6HX Telephone 01727 844988  
Email [sales@kenburn.co.uk](mailto:sales@kenburn.co.uk) [www.kenburn.co.uk](http://www.kenburn.co.uk)

Registered Office Church View Chambers 38 Market Square Toddington Dunstable Beds LU15 6BS  
Registered in England No: 2132685



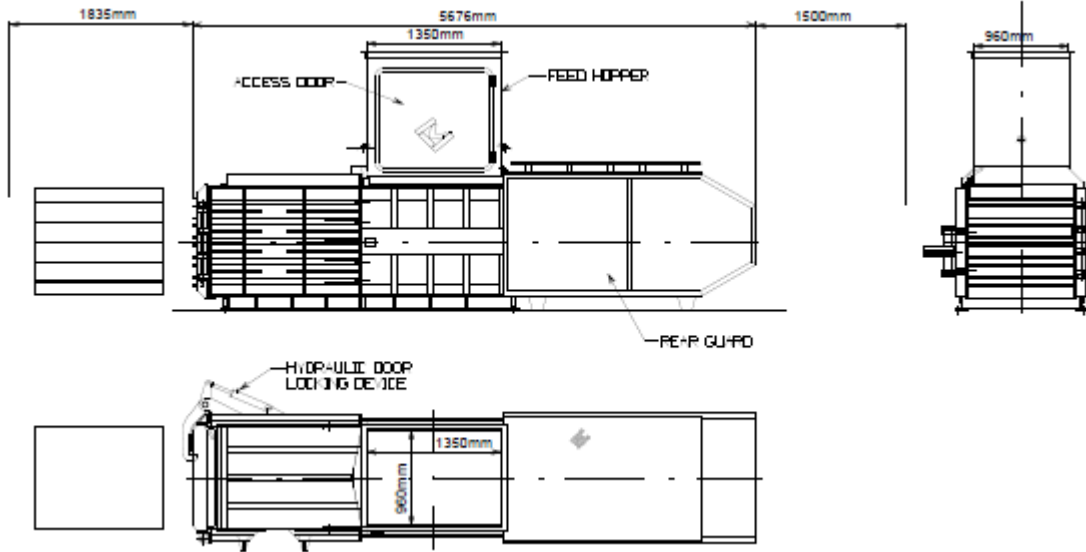

50 TONS PRESSURE  
SEMI-AUTOMATIC  
FEED HOPPER WITH SHEAR BLADE  
11KW MAIN MOTOR DRIVE  
BALE SIZE - APPROX. 1070 x 1000 x 1250mm LONG  
5 SLOTS FOR WIRE / STRAP

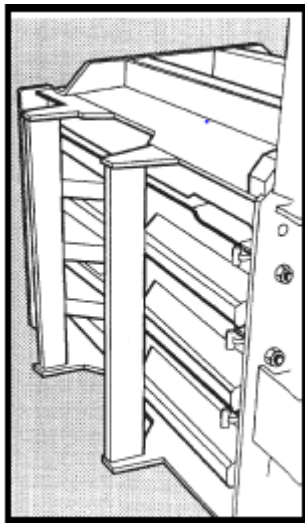

SIDE FRAME DESIGNED TO  
ACCEPT STRAPPING MACHINE.

Issue 2

November 2017



Kenburn Waste Management Limited Kenburn House Porters Wood  
St Albans Herts AL3 6HX Telephone 01727 844988  
Email [sales@kenburn.co.uk](mailto:sales@kenburn.co.uk) [www.kenburn.co.uk](http://www.kenburn.co.uk)

Registered Office Church View Chambers 38 Market Square Toddington Dunstable Beds LU15 6BS  
Registered in England No: 2132685

