



## Roto-Compactor PS 1400-E Typ 182

**Continuous filling also during compaction operation.**  
**For use directly on site where the waste is generated.**  
**Compaction into a plastic bag.**  
**For the compaction of recyclable waste and residual waste.**

### Technical Details:

The continuously fillable Roto-Compactor has a specially equipped compaction drum which rotates alternating right and left. It grips, tears up and compacts the material into a 1400 liter plastic bag that is protected by a steel casing and can be easily removed.

The full signal is effected by a yellow signal in the operator panel on the machine's front.

Paint on customer's request in every RAL colour.

### Serial Accessories:

- \* compaction drum: Power Cruncher drum
- \* adapter for pallets, mounted left and right side on central mast
- \* filling by faceplate
- \* 2K-paint in RAL 6018 yellowgreen

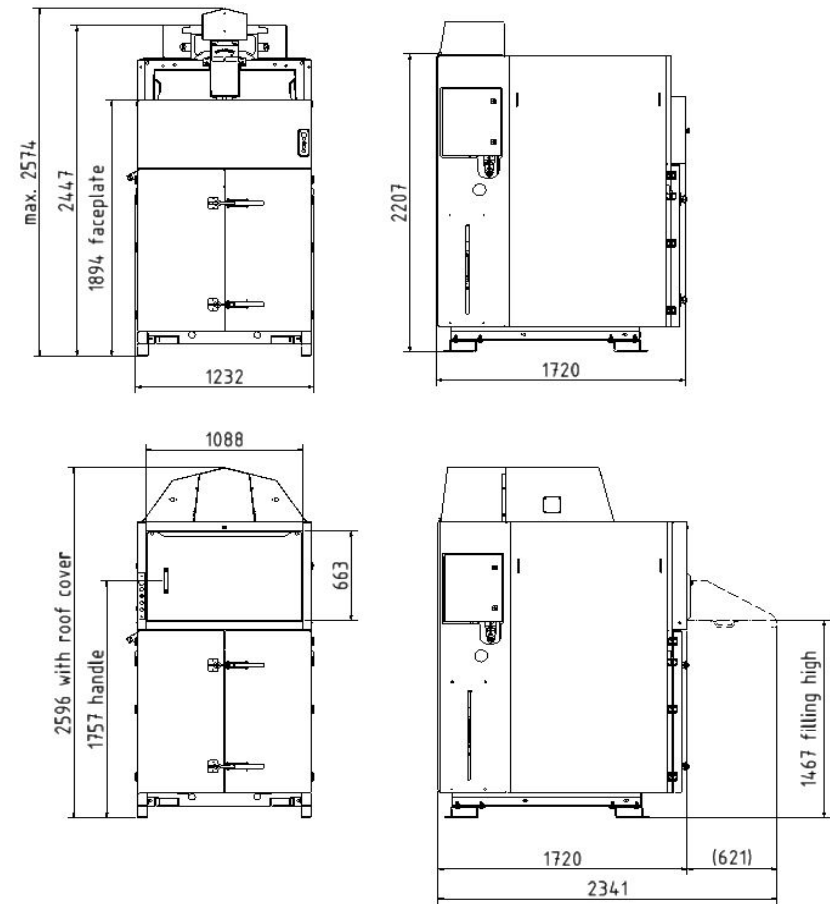

## Technical Data

All measurements are approx. measurements. Subject to changes.

power	3,0 kW
electrical connection	400V / 3phase / 50Hz +N
control voltage	24 V
drum speed	20 U/min optional 35 U/min
machine weight	1130 kg
noise level	69 dB
Pre-fuse	3 x 16A

dimensions machine (width x depth x height in mm)	1232 x 1720x 2450 (required space min.: 1330 mm)
bale dimensions (width x depth x height in mm)	1100 x 1200 x 1100 (equals to approx. 1400 liter)
max. height with extended compaction unit	2580 mm without roof cover (with roof cover 2600mm)
filling height	1890 mm (faceplate, 45°-chute) resp. 1470 mm (filling chute)
filling opening with accessory filling chute	660 mm x 1090 mm